

How To Draw A Maze.

<http://www.instructables.com/id/How-to-make-mazes/>

These are directions on how to draw a simple maze. All you need is a pencil and paper.

step 1. Outline.

Draw a square. Erase two wholes in it. I put mine in the corners as shown in the picture. This will be your entrance and exit.

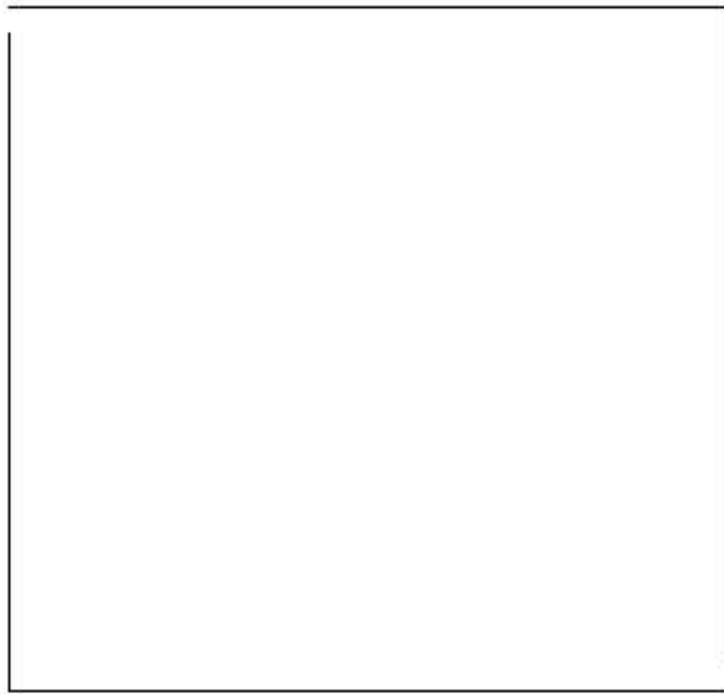

step 2.

Draw another square inside the first square. Erase more holes in that square. I made 3 holes in mine.

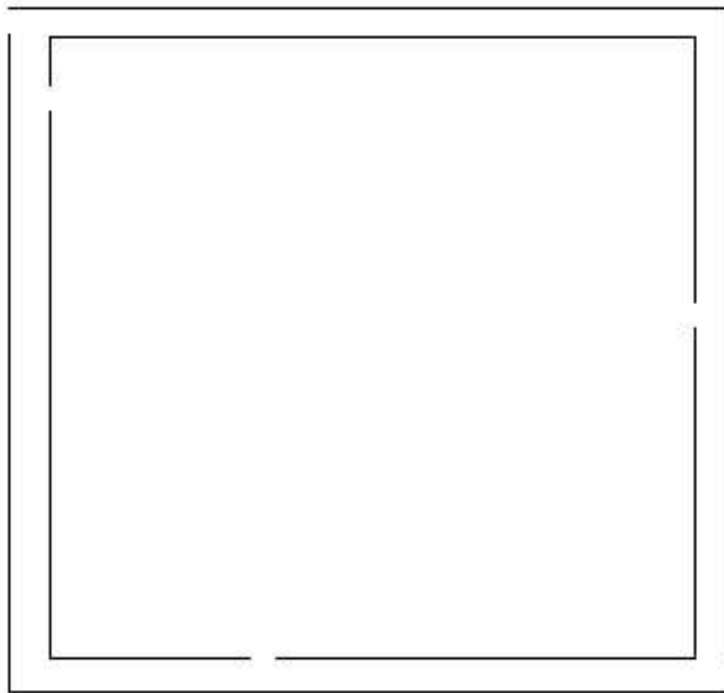

Step 3.

Draw more and more squares inside each other. Yours should look pretty close to mine, other than the holes.

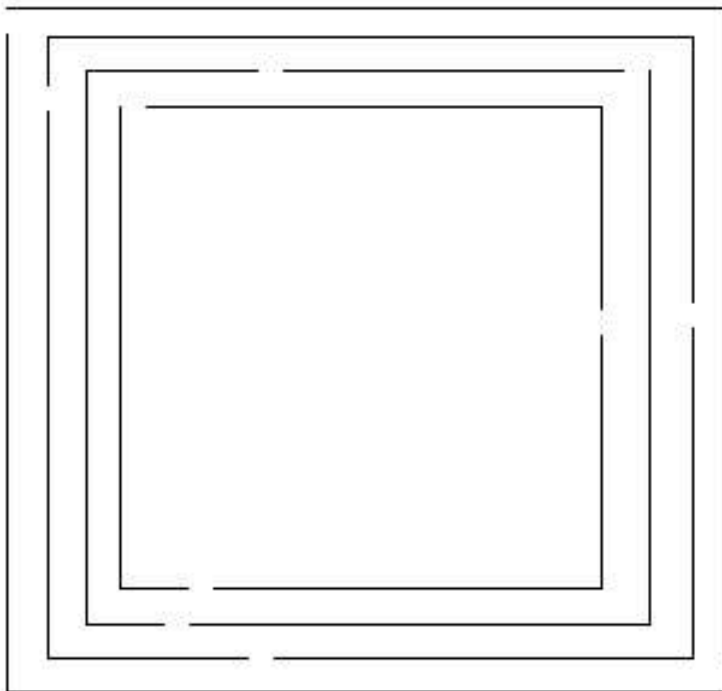

Step 4.

Now you can draw different shapes inside that square. Erase holes in them too.

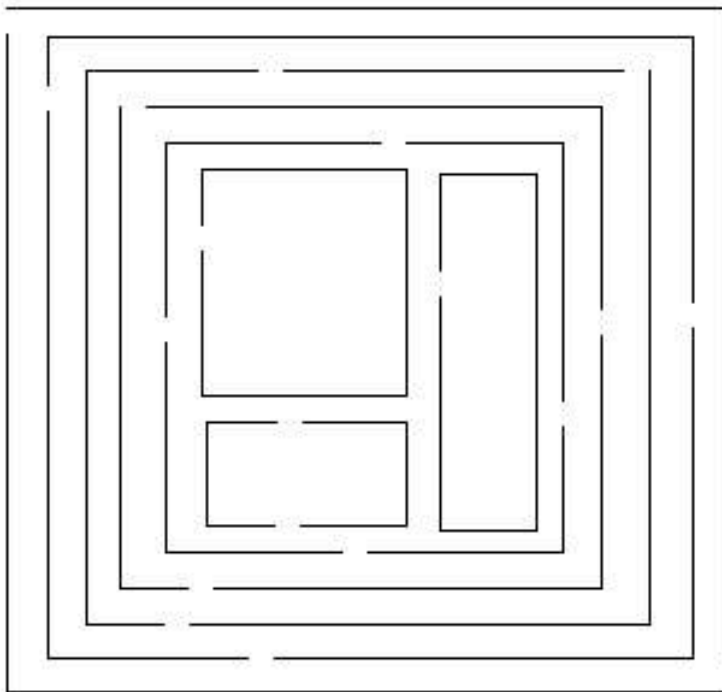

Step 5.

Fill those in with squares. Erase holes in those too.

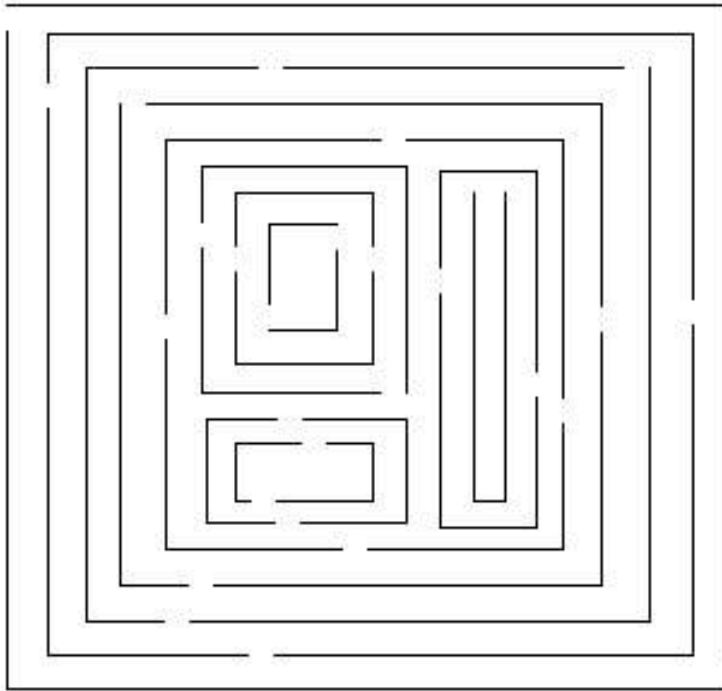

Step 9. All Done!

If you chose to highlight your route, erase the highlight. You have your very own maze now! Well... What are you waiting for? **GO SHOW IT OFF!**

